

# SLOKY®

Smart Torque, Everywhere Possible



2020~2021

## Torque Tool Innovation



# About us



**Predictable**



**Replaceable**



**Organized**

“SLOKY®” comes from the meaning of “SOLO KEY” in Taiwanese dialogue. It is defined from the position of patented adapter in torque screwdriver system as a solo performer.

Patented adapter plays as a solo performer, with a unique feature to build whole product system. The torque's value is set on the adapter; complied with various bits and handles become torque screwdrivers to tighten or loosen the screw.



It is considered to be used in everywhere needs torque control.

It has a greatest advantage of “no-over tighten”.

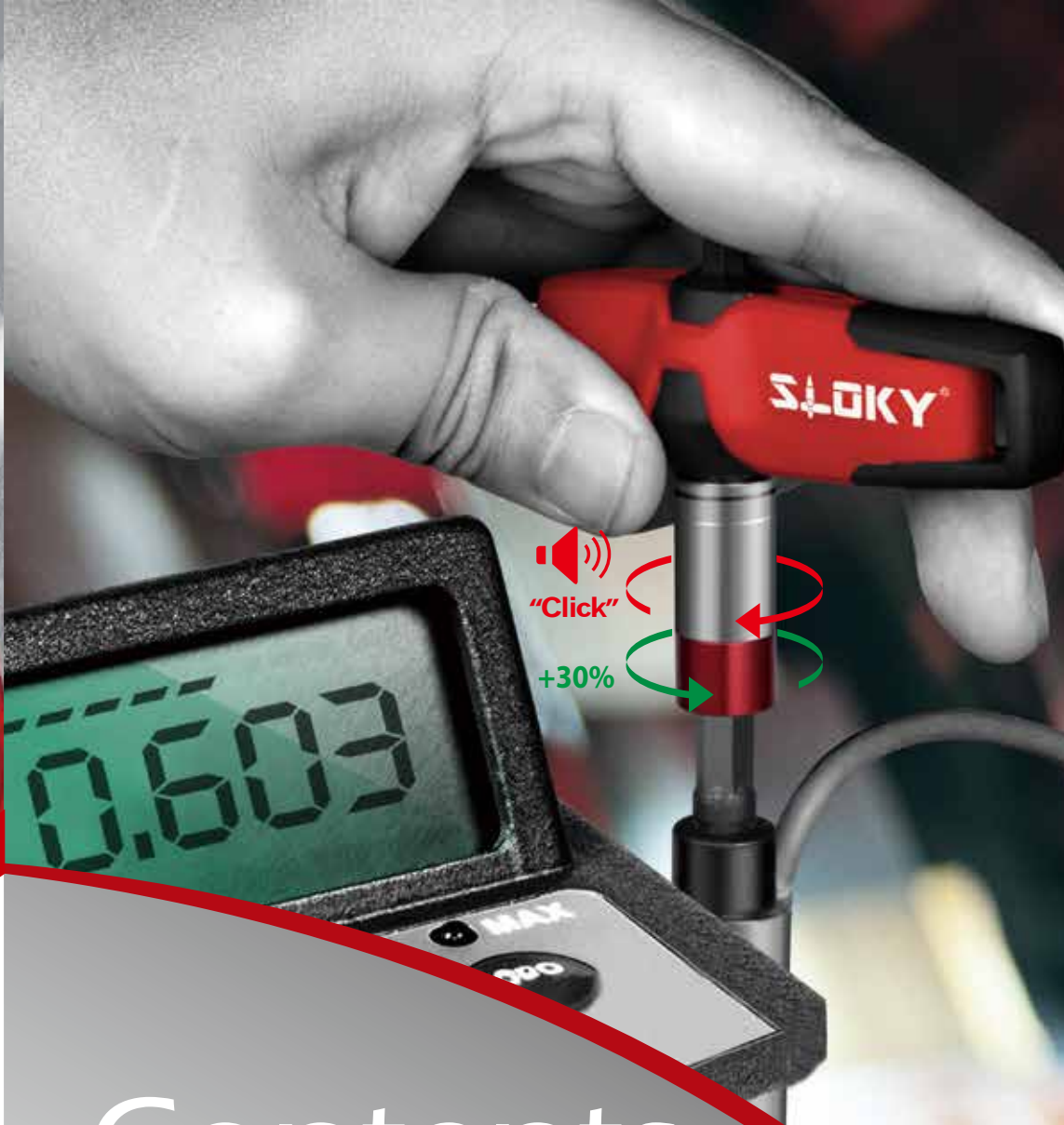
It prevents the damages of the screw and tool, in addition it provides a replaceable function to fit with driver bits having different shape and dimensions.



# Contents

- 01 Applications in Everywhere
- 20 Torque Screwdriver Kits
- 23 Torque Adapter
- 25 Handle
- 26 Bits   
- 28 Accessory | Special Inquiry
- 29 Quality Made

# Cutting Tools

Torque range from  
0.1 to 18.0 Nm

Special torque adapter,  
connecting and driving shapes  
are available on request.

## Industrial Applications

The SLOKY® torque tool is an ideal solution to supply precise insert screw tightening without stripping. It provides technicians and machine operators a convenient way to tighten up cutting tool screws, protects screws from damage, and guarantees a precision machining quality.



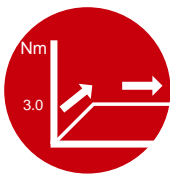

## No Over Tighten or Under Tighten

Torque remains the same value once reach the demand torque. No increase, No drop.



## "Click" Sound

A "Click" sound when the demand torque is reached.



## Fasten and Loosen by SAME tool

No need to change.



## Higher Reversible Torque

Reversible system. 30% higher torque for loosening.



### Ø10mm (STA) Small Torque Adapter

Range: 0.1 to 0.8 Nm

Connecting part:

DIN 3126 C6.3



Driving part:

DIN 3126 C6.3 / E6.3



### Ø12mm (A) Regular Torque Adapter

Range: 0.6 to 6.0 Nm

Connecting part:

DIN 3126 C6.3



Driving part:

DIN 3126 C6.3 / E6.3



### Ø20mm (ETA/ETB/ETC) Extend Torque Adapter

Range: 6.0 to 18.0 Nm

Connecting part:

DIN 3126 C6.3 and DIN 3120 square (1/4" or 3/8")



Driving part:

DIN 3126 C6.3 / E6.3 or DIN 3122/3123 square (3/8")

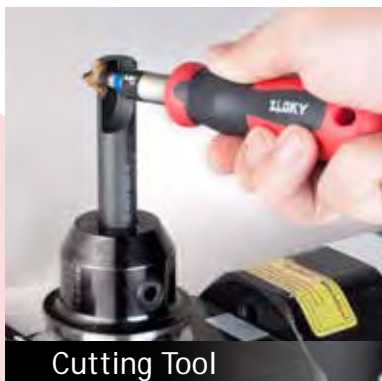

Cutting Tool

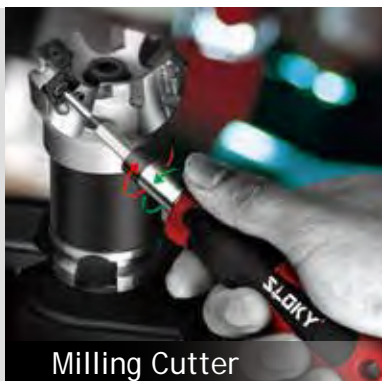

Milling Cutter



Turning Tool

# Clamping & Fixture

Torque range from  
0.6 to 18.0 Nm



Special torque adapter,  
connecting and driving shapes  
are available on request.

## Industrial Applications

A clamping system must hold the workpiece firmly against the locating elements, and be capable not to be affected by cutting forces developed and the vibration generated during operation. The SLOKY® torque screwdriver allows any technician to deliver the correct torque to the screws which can secure repeatable and accurate clamping. Properly clamping the fixture directly influences the accuracy, quality and production cycle time.

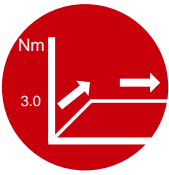

### No Over Tighten or Under Tighten

Torque remains the same value once reach the demand torque. No increase, No drop.



### "Click" Sound

A "Click" sound when the demand torque is reached.



### Fasten and Loosen by SAME tool

No need to change.



### Higher Reversible Torque

Reversible system. 30% higher torque for loosening.



### Ø12mm (A) Regular Torque Adapter

Range: 0.6 to 6.0 Nm

Connecting part:

DIN 3126 C6.3



Driving part:

DIN 3126 C6.3 / E6.3



### Ø20mm (ETA/ ETB/ ETC) Extend Torque Adapter

Range: 6.0 to 18.0 Nm

Connecting part:

DIN 3126 C6.3 and DIN 3120 square (1/4" or 3/8")



Driving part:

DIN 3126 C6.3 / E6.3 or DIN 3122/3123 square (3/8")

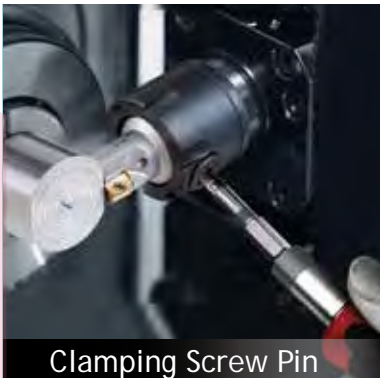

Clamping Screw Pin

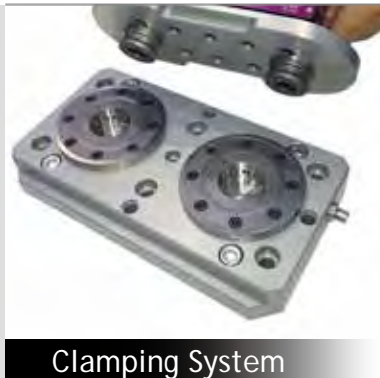

Clamping System



Quick Change Flanges



# Fastener & Hardware

Torque range from  
0.1 to 18.0 Nm



Special torque adapter,  
connecting and driving shapes  
are available on request.

## Industrial Applications

More and more screw connections in service or industry have to be tightened to a prescribed torque. Only the exact torque guarantees a secure fastening as well as a quick and easy loosening. Our SLOKY® torque screwdriver has a reversible system which can use the same screwdriver for tightening and loosening the screws.



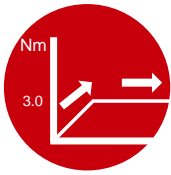

### No Over Tighten or Under Tighten

Torque remains the same value once reach the demand torque. No increase, No drop.



### "Click" Sound

A "Click" sound when the demand torque is reached.



### Fasten and Loosen by SAME tool

No need to change.



### Higher Reversible Torque

Reversible system. 30% higher torque for loosening.



#### Ø12mm (PTA) Power Tool E6.3 / C6 Torque Adapter

Range: 0.6 to 6.0 Nm

Connecting part:

DIN 3126 E6.3 or C6

Driving part:

DIN 3126 C6.3 / E6.3



#### Ø12mm (A) Regular Torque Adapter

Range: 0.6 to 6.0 Nm

Connecting part:

DIN 3126 C6.3

Driving part:

DIN 3126 C6.3 / E6.3



#### Ø8mm (MTA) Mini Torque Adapter

Range: 10 to 70 cNm

Connecting part:

4mm Hex

Driving part:

4mm Hex



#### Ø20mm (ETA/ETB/ETC) Extend Torque Adapter

Range: 6.0 to 18.0 Nm

Connecting part:

DIN 3126 C6.3 and DIN 3120 square (1/4" or 3/8")

Driving part:

DIN 3126 C6.3 / E6.3 or DIN 3122/3123 square (3/8")

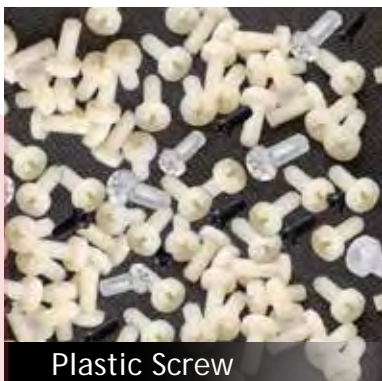

Plastic Screw



ESD Tool



Power Tool

# Micro- Technology

Torque range from  
0.1 to 6.0 Nm



Special torque adapter,  
connecting and driving shapes  
are available on request.

## Industrial Applications

Whether you manufacture high-value consumer goods or delicate electronics, the specification of the micro-technology torque range has been carefully created to satisfy your commercial needs. It optimizes assembly of low torque applications: watches, smart phones, cameras, glasses, jewelry, drone and other electronics products.

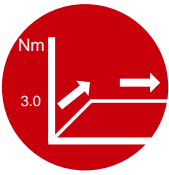

### No Over Tighten or Under Tighten

Torque remains the same value once reach the demand torque. No increase, No drop.



### "Click" Sound

A "Click" sound when the demand torque is reached.



### Fasten and Loosen by SAME tool

No need to change.



### Higher Reversible Torque

Reversible system. 30% higher torque for loosening.



### Ø8mm (MTA) Mini Torque Adapter

Range: 10 to 70 cNm

Connecting part:

4mm Hex



Driving part:

4mm Hex



### Ø10mm (STA) Small Torque Adapter

Range: 0.1 to 0.8Nm

Connecting part:

DIN 3126 C6.3



Driving part:

DIN 3126 C6.3 / E6.3



### Ø12mm (A) Regular Torque Adapter

Range: 0.6 to 6.0 Nm

Connecting part:

DIN 3126 C6.3



Driving part:

DIN 3126 C6.3 / E6.3



Camera Lens



Drone



Glasses



# 3C Device

Torque range from  
0.1 to 6.0 Nm



Special torque adapter,  
connecting and driving shapes  
are available on request.

## Industrial Applications

Electronics are something we rely on every day as the digital age marches forward. A number of devices we enjoy in our daily lives go up lead to the increasing demands for quality electronics assembly. Choosing SLOKY® torque tool, the accurate preset torque and reliable tool for assembly line can make large differences in productivity and quality as it can reduce defected products and minimize production downtime.

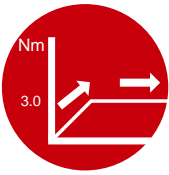

### No Over Tighten or Under Tighten

Torque remains the same value once reach the demand torque. No increase, No drop.



### "Click" Sound

A "Click" sound when the demand torque is reached.



### Fasten and Loosen by SAME tool

No need to change.



### Higher Reversible Torque

Reversible system. 30% higher torque for loosening.



### Ø8mm (MTA) Mini Torque Adapter

Range: 10 to 70 cNm

Connecting part:

4mm Hex



Driving part:

4mm Hex



### Ø10mm (STA) Small Torque Adapter

Range: 0.1 to 0.8 Nm

Connecting part:

DIN 3126 C6.3



Driving part:

DIN 3126 C6.3 / E6.3



### Ø12mm (A) Regular Torque Adapter

Range: 0.6 to 6.0 Nm

Connecting part:

DIN 3126 C6.3



Driving part:

DIN 3126 C6.3 / E6.3

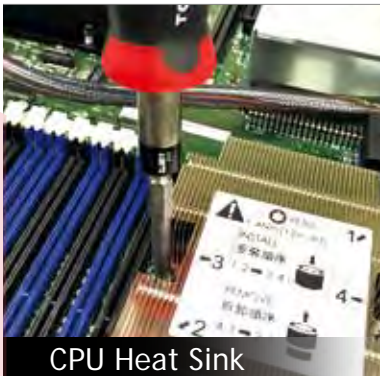

CPU Heat Sink

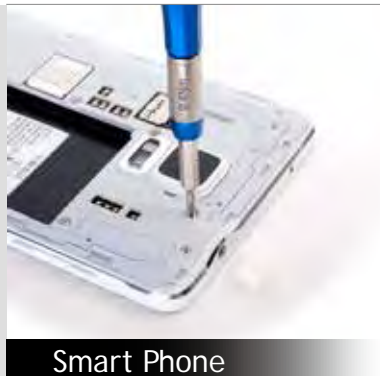

Smart Phone



Computer Assembly

# Medical

Torque range from  
0.1 to 6.0 Nm



Special torque adapter,  
connecting and driving shapes  
are available on request.

## Industrial Applications

Precision is everything in manufacturing, and that is doubly true for medical devices. Medical technology demands exceptional quality every time whether you use bone screws, implants, prostheses or any other medical devices. Precise torque control like SLOKY® torque tool plays a crucial foundation; otherwise, errors can have wide-reaching consequences.



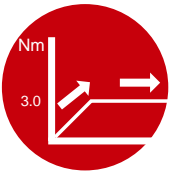

### No Over Tighten or Under Tighten

Torque remains the same value once reach the demand torque. No increase, No drop.



### "Click" Sound

A "Click" sound when the demand torque is reached.



### Fasten and Loosen by SAME tool

No need to change.



### Higher Reversible Torque

Reversible system. 30% higher torque for loosening.



### Special Made Torque Adapter

Range: 0.4 to 4.0 Nm

- Using medical grade material
- Connecting and driving parts can design to fit customer's handle and bits



### Ø10mm (STA) Small Torque Adapter

Range: 0.1 to 0.8 Nm

Connecting part:

DIN 3126 C6.3



Driving part:

DIN 3126 C6.3 / E6.3



### Ø12mm (A) Regular Torque Adapter

Range: 0.6 to 6.0 Nm

Connecting part:

DIN 3126 C6.3



Driving part:

DIN 3126 C6.3 / E6.3



Tooth Mold



Bone Plate



Surgical Instruments

# Musical Instrument

Torque range from  
0.1 to 6.0 Nm



Special torque adapter,  
connecting and driving shapes  
are available on request.

## Industrial Applications

Get rid of over-tighten or under-tighten risk. Always protect your musical instrument and play the most beautiful sounds from it. The SLOKY® torque tool can be set to a desired torque value to assist manufacturers in attaining more accurate fastening. It is an ideal for musical instrument production applications where over-torque conditions are not happened.



## No Over Tighten or Under Tighten

Torque remains the same value once reach the demand torque. No increase, No drop.



## "Click" Sound

A "Click" sound when the demand torque is reached.



## Fasten and Loosen by SAME tool

No need to change.



## Higher Reversible Torque

Reversible system. 30% higher torque for loosening.



### Ø8mm (MTA) Mini Torque Adapter

Range: 10 to 70 cNm

Connecting part:

4mm Hex



Driving part:

4mm Hex



### Ø10mm (STA) Small Torque Adapter

Range: 0.1 to 0.8 Nm

Connecting part:

DIN 3126 C6.3



Driving part:

DIN 3126 C6.3 / E6.3



### Ø12mm (A) Regular Torque Adapter

Range: 0.6 to 6.0 Nm

Connecting part:

DIN 3126 C6.3



Driving part:

DIN 3126 C6.3 / E6.3



Violin Rest System



Guitar



Drum



# Construction

Torque range from  
0.6 to 18.0 Nm

Special torque adapter,  
connecting and driving shapes  
are available on request.

## Industrial Applications

Easy & Simple! The SLOKY® torque screwdriver allows any user to deliver the correct torque with confidence in various fastening applications regardless of operator skill levels. The preset torque screwdriver is ideal for production applications where demand torque is met.

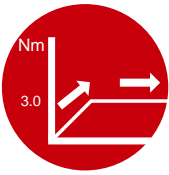

### No Over Tighten or Under Tighten

Torque remains the same value once reach the demand torque. No increase, No drop.



### "Click" Sound

A "Click" sound when the demand torque is reached.



### Fasten and Loosen by SAME tool

No need to change.



### Higher Reversible Torque

Reversible system. 30% higher torque for loosening.



### Ø12mm (A) Regular Torque Adapter

Range: 0.6 to 6.0 Nm

Connecting part:

DIN 3126 C6.3



Driving part:

DIN 3126 C6.3 / E6.3



### Ø12mm (PTA) Power Tool E6.3 / C6 Torque Adapter

Range: 0.6 to 6.0 Nm

Connecting part:

DIN 3126 E6.3 or C6



Driving part:

DIN 3126 C6.3 / E6.3



### Ø20mm (ETA/ ETB/ ETC) Extend Torque Adapter

Range: 6.0 to 18.0 Nm

Connecting part:

DIN 3126 C6.3 and DIN 3120 square (1/4" or 3/8")



Driving part:

DIN 3126 C6.3 / E6.3 or DIN 3122/3123 square (3/8")



Ceiling System

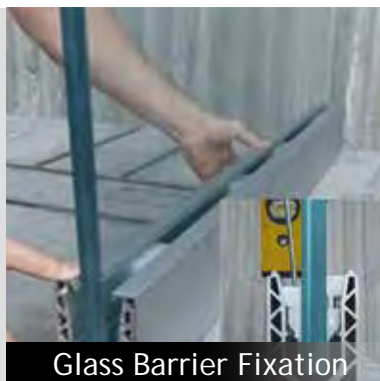

Glass Barrier Fixation

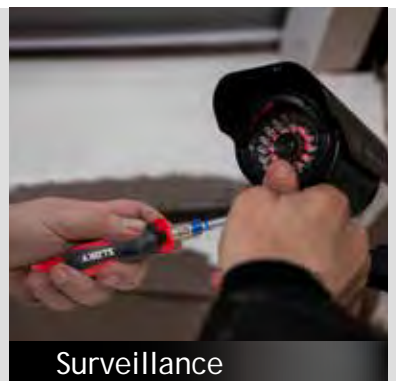

Surveillance



# Outdoor Sports

Torque range from 0.1 to 18.0 Nm



Special torque adapter, connecting and driving shapes are available on request.

## Industrial Applications

More and more modern sports equipment adopt lightweight components which require specific tension and tightening for each screw on the equipment, so it can ensure the component being well tightened and doesn't come loose when you are playing, or not too tight to break the screw while you are using it.

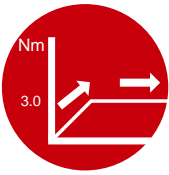

### No Over Tighten or Under Tighten

Torque remains the same value once reach the demand torque. No increase, No drop.



### "Click" Sound

A "Click" sound when the demand torque is reached.



### Fasten and Loosen by SAME tool

No need to change.



### Higher Reversible Torque

Reversible system. 30% higher torque for loosening.



### Ø8mm (MTA) Mini Torque Adapter

Range: 10 to 70 cNm

Connecting part:

4mm Hex



Driving part:

4mm Hex



### Ø12mm (A) Regular Torque Adapter

Range: 0.6 to 6.0 Nm

Connecting part:

DIN 3126 C6.3



Driving part:

DIN 3126 C6.3 / E6.3



### Ø20mm (ETA/ ETB/ ETC) Extend Torque Adapter

Range: 6.0 to 18.0 Nm

Connecting part:

DIN 3126 C6.3 and DIN 3120 square (1/4" or 3/8")



Driving part:

DIN 3126 C6.3 / E6.3 or DIN 3122/3123 square (3/8")



Gun Shooting



E-bike Display



Sports Shoes



# Pro Station



All in one! For professional using.

**Parts No.: 0-TPK26-PR-22K**

<b>Handle</b> (3 pcs)	Slim fit, Universal, T Flying			
<b>Applications</b>	Nm	TX	IP	Hex
(Torque Adapter: 8 pcs)	0.6	TX6	6IP	H1.5
(50mm Bits: 22 pcs)	0.9	TX7	7IP	-
	1.2	TX8	8IP	H2.0
	1.4	TX9	9IP	-
	2.0	TX10	10IP	H2.5
	3.0	TX15	15IP	H3.0
	5.0	TX20	20IP	H4.0
	5.5	TX25	25IP	H5.0
<b>Tool stand</b> (1 pc)	Included. Aluminum alloy			



N.W.: 1600g

# Tool Stand

For all Sloky torque tools.  
Made of aluminum alloy, silver coating.

**Parts No.: 0-TPK26-PR**

**Dimension (LxWxH)** 17 x 12 x 3 cm



N.W.: 1000g

# Togo Kit

Collecting the most popular torque tools.  
Ready to go.

**Parts No.: 0-TPK01-TGTX-12K** 

**0-TPK02-TGIP-12K** 

**0-TPK03-TGHX-12K** 



<b>Handle</b> (2 pcs)	Slim fit, Universal			
<b>Applications :</b>	Nm	TX	IP	Hex
(Torque Adapter: 6 pcs)	0.6	TX6	6IP	H1.5
(25mm Bits: 6 pcs)	0.9	TX7	7IP	-
(50mm Bits: 6 pcs)	1.2	TX8	8IP	H2.0
	1.4	TX9	9IP	-
	2.0	TX10	10IP	H2.5
	3.0	TX15	15IP	H3.0
	5.0	-	-	H4.0
	5.5	-	-	H5.0
<b>Case</b>	Included			



N.W.: 445g

# Work Station

For your long time using and storage.

- Parts No.: 0-TPK01-PR-12K** 
- 0-TPK02-PR-12K** 
- 0-TPK03-PR-12K** 

<b>Handle</b> (6 pcs)	Slim fit (3), Universal (3)			
<b>Applications</b>	Nm	TX	IP	Hex
(Torque Adapter: 6 pcs)	0.6	TX6	6IP	H1.5
(25mm Bits: 6 pcs)	0.9	TX7	7IP	-
(50mm Bits: 6 pcs)	1.2	TX8	8IP	H2.0
	1.4	TX9	9IP	-
	2.0	TX10	10IP	H2.5
	3.0	TX15	15IP	H3.0
	5.0	-	-	H4.0
	5.5	-	-	H5.0
<b>Stand</b> (1 pc)	Included. Rimmed steel (SPCC)			



N.W.: 855g

# Smart Kit

Cover the smallest 0.6Nm to biggest 5.5Nm adapters with one universal handle.

- Parts No.: 0-TPK01-99-06K** 

<b>Handle</b> (1 pc)	Universal	
<b>Applications</b>	Nm	TX
(Torque Adapter: 6 pcs)	0.6	TX6
(25mm Bits: 6 pcs)	0.9	TX7
	1.2	TX8
	2.0	TX9
	3.0	TX15
	5.5	TX20
<b>Case</b>	Included	



N.W.: 290g

# Adapter Kit

Create your own exclusive kit. Choose any 12 adapters.

- Parts No.: 0-TPK12-EX**

<b>Torque Adapter</b>	Nm		
(12 pcs)	0.6	2.0	4.0
	0.9	2.5	4.5
	1.2	3.0	5.0
	1.4	3.8	5.5
<b>Case</b>	Included		



(MOQ: 3 kits)

N.W.: 370g

# Single Set Economical Starter for 0.6 / 0.9 / 1.2 Nm

Parts No.: 0-TPK01-TX-\*\*\*-S



0-TPK02-IP-\*\*\*-S



0-TPK03-H-\*\*\*



Handle (1 pc) Slim fit

Applications :	Nm	TX	IP	Hex
(Torque Adapter: 1 pc)	0.6	TX6	6IP	-
(25mm Bits: 2 pcs)	0.9	TX7	7IP	-
(50mm Bits: 2 pcs)	1.2	TX8	8IP	H2.0

Case Included

Order Example : To order TX6 bits, 0.6Nm,  
parts no. is 0-TPK01-TX06-0.6-S



N.W.: 122g

# Single Set Economical Starter for 1.4 / 2.0 / 3.0 / 5.0 / 5.5 Nm

Parts No.: 0-TPK01-TX-\*\*\*



0-TPK02-IP-\*\*\*



0-TPK03-H-\*\*\*



Handle (1 pc) Universal

Applications	Nm	TX	IP	Hex
(Torque Adapter: 1 pc)	1.4	TX9	9IP	-
(25mm Bits: 2 pcs)	2.0	TX8	-	-
(50mm Bits: 2 pcs)	2.0	TX9	-	-
	2.0	TX10	10IP	H2.5
	3.0	TX15	15IP	H3.0
	5.0	TX20	20IP	-
	5.5	TX20	-	-

Case Included

Order Example : To order 9IP bits, 1.4Nm  
parts no. is 0-TPK02- 9IP-1.4



N.W.: 130g

# Single Set Economical Starter for 5.0 / 5.5 Nm

Parts No.: 0-TPK01-TX2025-5.5



0-TPK02-2025IP-5.5



0-TPK03-H040-5.0



Handle : T flying

Applications :	Nm	TX	IP	Hex
(Torque Adapter: 1 pc)	5.0	-	-	H4.0
(50mm Bits: 4 pcs)	5.5	TX20/ TX25	20IP/ 25IP	-

Case Included

Order Example : To order H4.0 bits, 5.0Nm  
parts no. is 0-TPK03-H040-5.0



N.W.: 200g

# Adapter

- Torque tested to DIN EN ISO 6789
- 20,000 times product life test
- 30% Higher torque for loosening
- Torque Accuracy :  $\pm 10\%$
- Installed with magnet for C6.3 and E6.3 bits
- Color ring is popular for industrial standard

▪ Special torque adapter is available on request.

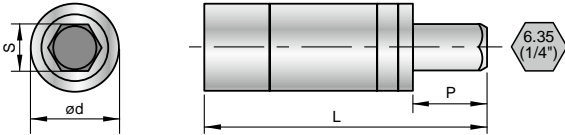

## Regular Torque Adapter (A)

▪ Torque range : 0.6-5.7Nm

Parts No.	Nm	KgfcM	In-lb	Q'TY	Ød (mm)	Driving (mm)	P (mm)	L (mm)	N.W.
0-TPK-A06-0.6	0.6	6.1	5.3	3 pcs	12	DIN 3126 1/4" Hex (6.35mm)	10	38.3	80g
0-TPK-A07-0.9	0.9	9.2	8.0						
0-TPK-A08-1.2	1.2	12.0	10.6						
0-TPK-A08-2.0	2.0	20.4	17.7						
0-TPK-A09-1.4	1.4	14.0	12.4						
0-TPK-A09-2.0	2.0	20.4	17.7						
0-TPK-A10-2.0	2.0	20.4	17.7						
0-TPK-A15-3.0	3.0	30.6	26.6						
0-TPK-A20-5.0	5.0	51.0	44.3						
0-TPK-A20-5.5	5.5	56.1	48.7						
0-TPK-A25-5.5	5.5	56.1	48.7	3 pcs	12	DIN 3126 1/4" Hex (6.35mm)	10	38.3	80g
0-TPK-A00-1.0	1.0	10.2	8.8						
0-TPK-A00-1.5	1.5	15.3	13.3						
0-TPK-A00-2.2	2.2	22.4	19.5						
0-TPK-A00-2.5	2.5	25.5	22.1						
0-TPK-A00-3.5	3.5	35.7	31.0						
0-TPK-A00-3.8	3.8	38.7	33.6						
0-TPK-A00-4.0	4.0	40.8	35.4						
0-TPK-A00-4.5	4.5	45.9	39.8						
0-TPK-A00-5.7	5.7	58.0	50.4						

## Small Torque Adapter (STA)

▪ Torque range : 0.1-0.8Nm

Parts No.	Nm	KgfcM	In-lb	Q'TY	Ød (mm)	Driving (mm)	P (mm)	L (mm)	N.W.
0-TPK-STA-0.1	0.1	1.0	0.9	3 pcs	10	DIN 3126 1/4" Hex (6.35mm)	10	34.5	60g
0-TPK-STA-0.2	0.2	2.0	1.8						
0-TPK-STA-0.3	0.3	3.1	2.7						
0-TPK-STA-0.4	0.4	4.1	3.5						
0-TPK-STA-0.5	0.5	5.1	4.4						
0-TPK-STA-0.6	0.6	6.1	5.3						
0-TPK-STA-0.7	0.7	7.1	6.2						
0-TPK-STA-0.8	0.8	8.2	7.0						



# Adapter

▪ Special torque adapter is available on request.

## Mini Torque Adapter (MTA)

- Torque range : 10-70cNm
- Torque tested to DIN EN ISO 6789
- 20,000 times product life test
- 30% Higher torque for loosening
- Torque Accuracy : ±10%
- Installed with magnet

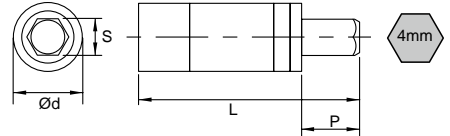

Parts No.	cNm	KgfcM	In-lb	Q'TY	Ød (mm)	Driving (mm)	P (mm)	L (mm)	N.W.
0-TPK-MTA-0.1	10	1.0	0.9	3 pcs	8	4mm Hex	10	32	35g
0-TPK-MTA-0.2	20	2.0	1.8						
0-TPK-MTA-0.3	30	3.1	2.7						
0-TPK-MTA-0.4	40	4.1	3.5						
0-TPK-MTA-0.5	50	5.1	4.4						
0-TPK-MTA-0.6	60	6.1	5.3						
0-TPK-MTA-0.7	70	7.1	6.2						

## Extend Torque Adapter (ETA/ ETB/ ETC)

- Torque range : 6-18Nm
- Torque tested to DIN EN ISO 6789
- 20,000 times product life test
- 30% Higher torque for loosening
- Torque Accuracy : ±10%
- Installed with magnet

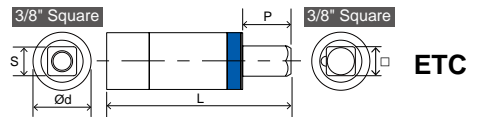
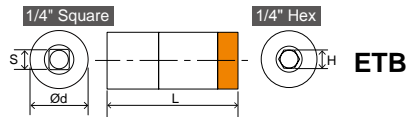
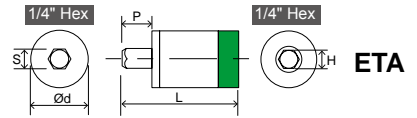

Parts No.	Nm	KgfcM	Inlb	Q'TY	Ød(mm)	Connecting	P(mm)	L(mm)	Driving
0-TPK-ETA-6.0	6.0	61.1	53.1	1 pcs	20	DIN 3126 1/4" Hex	10	43.5	DIN 3126 1/4" Hex
0-TPK-ETA-7.0	7.0	71.3	62.0						
0-TPK-ETA-8.0	8.0	81.5	70.8						
0-TPK-ETA-10.0	10.0	101.9	88.5						
0-TPK-ETB-8.0	8.0	81.5	70.8	1 pcs	20	DIN 3120 1/4" Square	--	44.5	DIN 3126 1/4" Hex
0-TPK-ETB-10.0	10.0	101.9	88.5						
0-TPK-ETB-12.0	12.0	122.3	106.2						
0-TPK-ETB-15.0	15.0	152.9	132.8						
0-TPK-ETB-18.0	18.0	183.4	159.3	1 pcs	20	DIN 3120 3/8" Square	12	53.0	DIN 3122 / DIN 3123 3/8" Square
0-TPK-ETC-8.0	8.0	81.5	70.8						
0-TPK-ETC-10.0	10.0	101.9	88.5						
0-TPK-ETC-12.0	12.0	122.3	106.2						
0-TPK-ETC-15.0	15.0	152.9	132.8						
0-TPK-ETC-18.0	18.0	183.4	159.3						

# Handle

- Different types of handle to cover all torque adapters.
- The soft zone is comfortable to hold and play very flexible.
- Easy to tighten and loosen screws even in higher torque range.
- Fits perfectly into the hand and prevents the hand injuries such as blisters and calluses.



## Universal

Features :

- Universal type for holding in multi-ways.
- Having large support surfaces for thumb and index finger ease of using and efficiency.
- Innovation flag design, driving the screw easily.

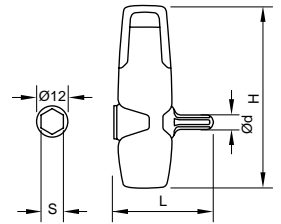

Fig	Parts No.	Suit For Torque	S (mm)	L (mm)	H (mm)	Ød (mm)	N.W.
1	0-TPK-H01	0.6~5.5 Nm	6.35 (1/4")	37.5	70.7	5	25g
	0-TPK-H01-B						

## Slim-fit

Features :

- Comfortable holding, for accurate and efficient while fastening and loosening small size screws.

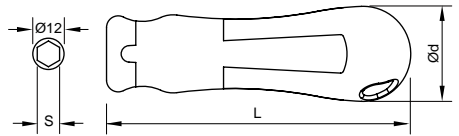

Fig	Parts No.	Suit For Torque	S (mm)	L (mm)	Ød (mm)	N.W.
2	0-TPK-H02	0.6~2.0 Nm	6.35 (1/4")	104	32.5	50g
	0-TPK-H02-B					

## T flying

Features :

- It is light, even it is designed for higher torque.
- The striking soft zone that allows particularly comfortable for using at higher torque.

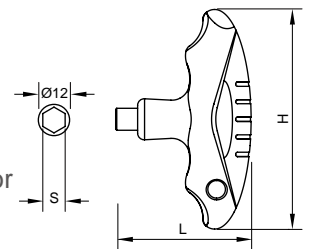

Fig	Parts No.	Suit For Torque	S (mm)	L (mm)	H (mm)	N.W.
3	0-TPK-H03	3.0~6.0 Nm	6.35 (1/4")	65	100	60g
	0-TPK-H03-B					

## Mini handle

Features :

- Fit with 4mm hexagon bits.
- Material: Aluminum alloy.

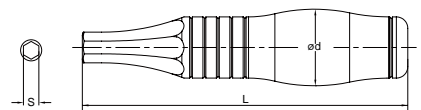

Fig	Parts No.	Suit For Torque	S (mm)	L (mm)	Ød (mm)	N.W.
4	0-TPK-H05	10~70 cNm	4	85	20	70g

# Bits

- High quality and precision bits.
- Made by high alloy steel with HRC58°~60°.
- Standard : DIN3126 - C6.3 (1/4") or E6.3 (1/4")



**25 / 50 / 75 mm for TORX® screw**

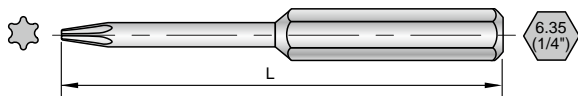

Parts No.	Driver Size	L (mm)	Q'TY	N.W.
0-TPK-B01-TX06-25	TX6	25	6 pcs	32 g
0-TPK-B01-TX07-25	TX7			32 g
0-TPK-B01-TX08-25	TX8			32 g
0-TPK-B01-TX09-25	TX9			32 g
0-TPK-B01-TX10-25	TX10			32 g
0-TPK-B01-TX15-25	TX15			34 g
0-TPK-B01-TX20-25	TX20			34 g
0-TPK-B01-TX06-50	TX6			50
0-TPK-B01-TX07-50	TX7	54 g		
0-TPK-B01-TX08-50	TX8	54 g		
0-TPK-B01-TX09-50	TX9	56 g		
0-TPK-B01-TX10-50	TX10	58 g		
0-TPK-B01-TX15-50	TX15	60 g		
0-TPK-B01-TX20-50	TX20	62 g		
0-TPK-B01-TX25-50	TX25	62 g		
0-TPK-B01-TX08-75	TX8	75	6 pcs	58 g
0-TPK-B01-TX09-75	TX9			64 g
0-TPK-B01-TX10-75	TX10			70 g
0-TPK-B01-TX15-75	TX15			70 g
0-TPK-B01-TX20-75	TX20			78 g
0-TPK-B01-TX25-75	TX25			88 g

TORX® and TORX PLUS® are registered trademarks of Acument Global Technologies.



## 25 / 50 / 75 mm for TORX PLUS® screw

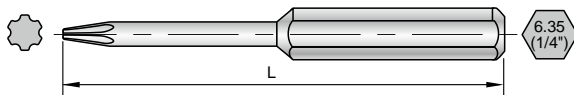

Parts No.	Driver Size	L (mm)	Q'TY	N.W.
0-TPK-B02- 6IP-25	6IP	25	6 pcs	32 g
0-TPK-B02- 7IP-25	7IP			32 g
0-TPK-B02- 8IP-25	8IP			32 g
0-TPK-B02- 9IP-25	9IP			32 g
0-TPK-B02-10IP-25	10IP			32 g
0-TPK-B02-15IP-25	15IP			34 g
0-TPK-B02-20IP-25	20IP	50	6 pcs	34 g
0-TPK-B02- 6IP-50	6IP			54 g
0-TPK-B02- 7IP-50	7IP			54 g
0-TPK-B02- 8IP-50	8IP			54 g
0-TPK-B02- 9IP-50	9IP			56 g
0-TPK-B02-10IP-50	10IP			58 g
0-TPK-B02-15IP-50	15IP	75	6 pcs	60 g
0-TPK-B02-20IP-50	20IP			62 g
0-TPK-B02-25IP-50	25IP			62 g
0-TPK-B02- 8IP-75	8IP			58 g
0-TPK-B02- 9IP-75	9IP			64 g
0-TPK-B02-10IP-75	10IP			70 g
0-TPK-B02-15IP-75	15IP	75	6 pcs	70 g
0-TPK-B02-20IP-75	20IP			78 g
0-TPK-B02-25IP-75	25IP			88 g



## 25 / 50 mm for HEXAGON screw

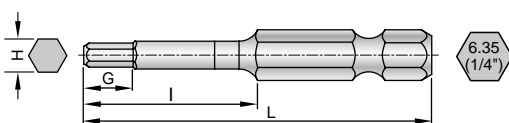

Parts No.	Driver Size	H (mm)	G (mm)	I (mm)	L (mm)	Q'TY	N.W.
0-TPK-B03-H015-25	H1.5	1.5	2.3	-	25	6 pcs	32 g
0-TPK-B03-H020-25	H2	2.0	3.0				32 g
0-TPK-B03-H025-25	H2.5	2.5	3.8				33 g
0-TPK-B03-H030-25	H3	3.0	4.5				34 g
0-TPK-B03-H040-25	H4	4.0	6.0				36 g
0-TPK-B03-H050-25	H5	5.0	7.5				40 g
0-TPK-B03-H015-50	H1.5	1.5	2.3	25	50	6 pcs	50 g
0-TPK-B03-H020-50	H2	2.0	3.0				51 g
0-TPK-B03-H025-50	H2.5	2.5	3.8				54 g
0-TPK-B03-H030-50	H3	3.0	4.5				57 g
0-TPK-B03-H040-50	H4	4.0	6.0				64 g
0-TPK-B03-H050-50	H5	5.0	7.5				72 g



# Accessory

## Torque Analyzer (Made in Japan)

**Parts No.: 08-CD-100M**



<b>Model No.</b>		<b>CD-100M</b>	
<b>Measuring Range</b>	Nm	0.10~10.00	
	kgf-cm	1.0~100.0	
	lbf-in	1.0~90.0	
<b>Accuracy</b>		±0.5% (199 or less digit ± 1 digit)	
<b>Display</b>		The 3.5 figures digital display of LCD	
<b>Measurement Mode</b>	P-P	The maximum under measurement is always displayed.	
	T-R	The value of the load torque concerning a detector is displayed as it is.	
	P-D	A value when a load torque value changes from a rise to descent is displayed.	
<b>Transmission interface</b>		USB (Baud rate : 19200)	
<b>Auto Power Off</b>		Power-supply OFF is carried out after the neglect during 10 minutes.	
<b>Battery</b>		Ni-cd battery : 1.2V/5sells (700mAh)	
<b>Charge time / Use time</b>		About 3 hours / About 12 hours use consecutive at full charge time	
<b>Size / Weight</b>		160(W) X 125(D) X 55(H)mm / 1kg	
<b>Measurement Joint</b>	<b>Spec.</b>	SJ-10	SJ-50
	<b>Measurement Range</b>	0.1~1.0 Nm	0.5~5.0 Nm

## Special Inquiry

email to :  
sloky@jimmore.com.tw

Driving

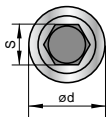

Connecting

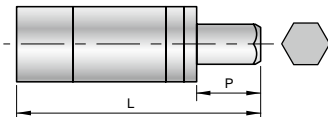

From:  
Company / Name

Contact mail

Driving Part :

- Male     Hexagon  
 Female     Square

Size: \_\_\_\_\_ mm/inch

Torque range :

\_\_\_\_\_ Nm

Bits :

\_\_\_\_\_

Handle :

\_\_\_\_\_

Connecting Part :

- Male     Hexagon  
 Female     Square

Size: \_\_\_\_\_ mm/inch

Tolerance :     ± 10%     ± 6%

Package :

\_\_\_\_\_

Co-Brand :

\_\_\_\_\_

# Quality Made

## Certificate

Presisting highest quality to supply SLOKY® products and services to meet cutomer's satisfactions.

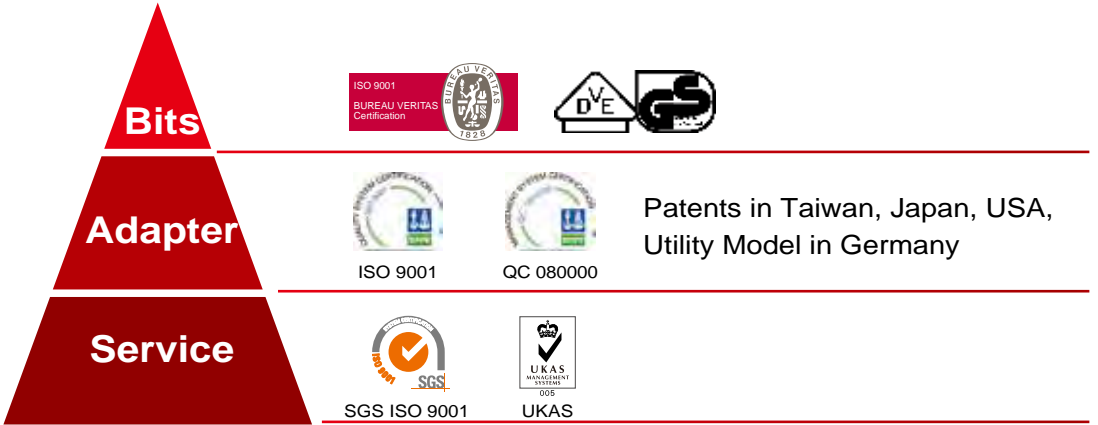

## Laboratory Systems

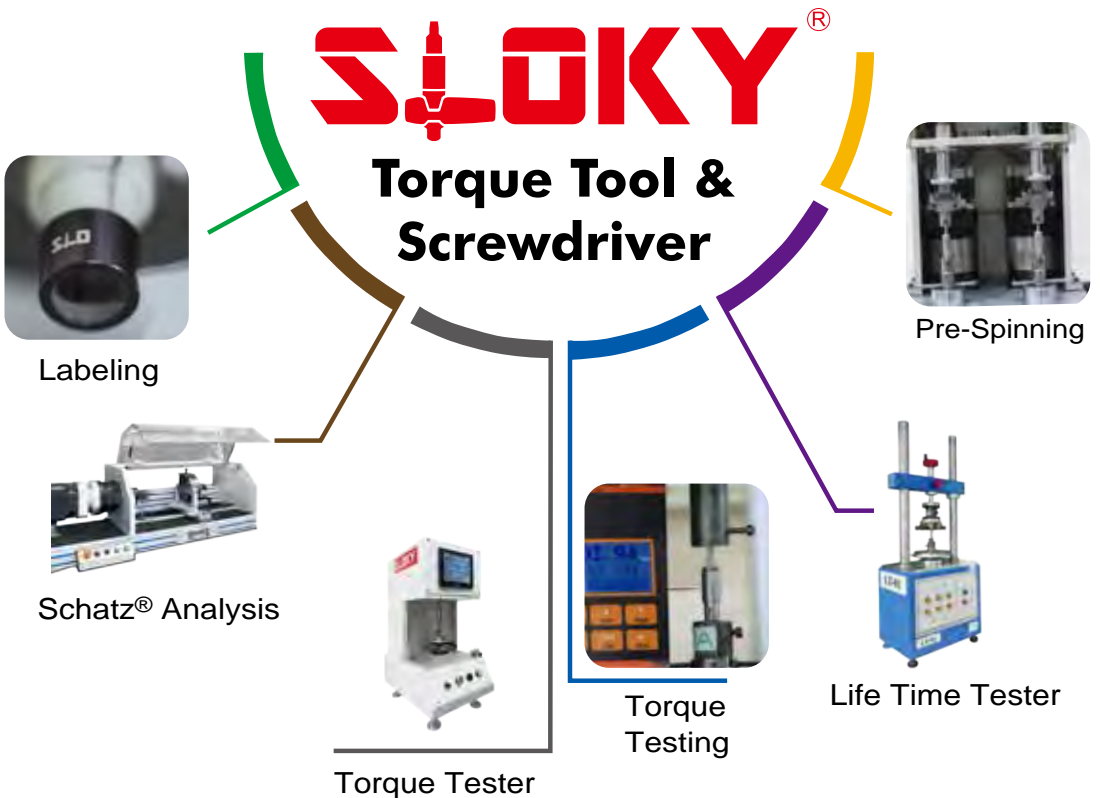



**JIMMORE**  
International Corp.



Subject to change without notice. ©Jimmore International Corp. 201912 Cat. 20-21 : 1000SC

